

▲ FEATURES

85°C , 2000 hours assured.
Chip type large capacitance capacitors.

▲ GENERAL DIMENSIONS & PERMISSIBLE RIPPLE CURRENT

LEAD SPACING AND DIAMETER							Unit:mm
Dψ	L	A	B	C	W	P±0.2	
4	5.3±0.2	4.3	4.3	2.0	0.5~0.8	1.0	
5	5.3±0.2	5.3	5.3	2.3	0.5~0.8	1.5	
6.3	5.3±0.2	6.6	6.6	2.7	0.5~0.8	2.0	
6.3	7.7±0.3	6.6	6.6	2.7	0.5~0.8	2.0	
8	6.5±0.3	8.4	8.4	3.4	0.5~0.8	2.3	
8	10±0.5	8.4	8.4	3.0	0.7~1.1	3.1	
10	10±0.5	10.4	10.4	3.3	0.7~1.1	4.7	

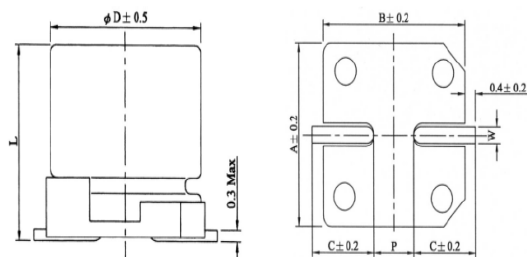

▲ Case Size

uf	4.0V		6.3V		10V		16V		25V		35V		50V	
	DxL	mA	DxL	mA	DxL	mA	DxL	mA	DxL	mA	DxL	mA	DxL	mA
0.1													4x5.5	1.0
0.22													4x5.5	2.0
0.33													4x5.5	2.8
0.47													4x5.5	4.0
1													4x5.5	8.4
2.2													4x5.5	14
3.3													4x5.5	17
4.7									4x5.5	18	4x5.5	18	4x5.5	22
10					4x5.5	21	4x5.5	23	4x5.5	27	4x5.5	29	6.3x5.5	35
22			4x5.5	29	4x5.5	33	4x5.5	37	5x5.5	40	5x5.5	45	6.3x7.7	75
									6.3x5.5	40	6.3x5.5	48	8x6.5	80
33			4x5.5	30	4x5.5	41	5x5.5	45	5x5.5	46	6.3x5.5	58	6.3x7.7	188
			5x5.5	37	5x5.5	43			6.3x5.5	54			8x6.5	200
47			4x5.5	40	5x5.5	52	5x5.5	50	6.3x5.5	60	6.3x5.5	65	6.3x7.7	225
	4x5.5	28	5x5.5	46										
100	4x5.5	34	5x5.5	70	6.3x5.5	76	6.3x5.5	100	6.3x7.7	150	6.3x7.7	250	8x10.5	300
									8x6.5	160	8x10.5	280		
220	6.3x5.5	61	6.3x7.7	141	6.3x7.7	170	6.3x7.7	185	8x10.5	300	10x10.5	400	10x10.5	450
			8x6.5	150	8x6.5	190	8x10.5	290						
330	6.3x7.7	135	6.3x7.7	197	8x10.5	330	8x10.5	330	10x10.5	450	10x10.5	460		
	8x6.5	145	8x6.5	210										
470	8x6.5	220	8x10.5	380	8x10.5	420	10x10.5	480	10x10.5	460				
	8x10.5	220												
560	8x10.5	242	8x10.5	410	10x10.5	450	10x10.5	500						
680	8x10.5	285	8x10.5	460	10x10.5	480								
1000	10x10.5	370	10x10.5	500	10x10.5	510					16x16.5			
1200	10x10.5	410	10x10.5	510										
1500	10x10.5	470	10x10.5	530										

▲ Specifications

Operating Temperature Range	-40 ~+ 85°C								
Rated Voltage Range	4~50VDC								
Capacitance Range	0.1 ~1500 u F								
Capacitance Tolerance	±20% (120 HZ , +20°C)								
Leakage Current (+20°C)	1 ≤ 0.01CV or 3 u A after 2 minutes ,whichever is greater measured with rate working voltage applied.								
Dissipation Factor (tanα ,at 20°C,120Hz)	Rated Voltage(VDC)		4	6.3	10	16	25	35	50
	D.F.%	ψ 4~6.3	42	30	22	18	16	14	14
	max	ψ 8~10	45	24	26	20	16	14	14
Low Temperature Characteristics at 120HZ	impedance ratio max								
	Rated Voltage(VDC)		4	6.3	10	16	25	35	50
	Z-25°C / AZ+20°C		7	4	3	2	2	2	2
	Z-40°C / AZ+20°C		15	8	8	4	4	3	3

ODER: LV 10U 16V 4x5.5 SMD

PS:如果工作溫度不高,85°C的壽命其實表現的也不錯.每差10°C壽命約可提升1倍